

**GENERAL NOTES**

1. THE PROPOSED WORKS SHOWN ARE AT A CONCEPTUAL DESIGN STAGE, AND THE LAND ACQUISITION BOUNDARIES MAY BE SUBJECT TO CHANGE.
2. PRIVATE AND COMMON LAND BOUNDARIES ARE BASED UPON THE PLAN SHOWN ON SHEET 42A AND REGISTER UNIT NO. CL77. IT IS ASSUMED THAT THIS PLAN SUPERSEDES THE PLAN SHOWN ON SHEET 42 AND THE CURRENT INFORMATION HELD ONLINE THROUGH THE PLANNING GIS.
3. LAND BOUNDARIES AND TITLE NUMBERS SHOWN ARE TO BE CHECKED AND VERIFIED BY WORCESTERSHIRE COUNTY COUNCIL

**NOTES**

**KEY**

- LAND ACQUISITION BOUNDARY (OUTSIDE OF HIGHWAY BOUNDARY)
- LAND ACQUISITION
- RIGHTS FOR PERMANENT OR TEMPORARY LAND OCCUPATION
- POSSIBLE AREA OF LAND COMPENSATION (OUTSIDE OF COMMON LAND)

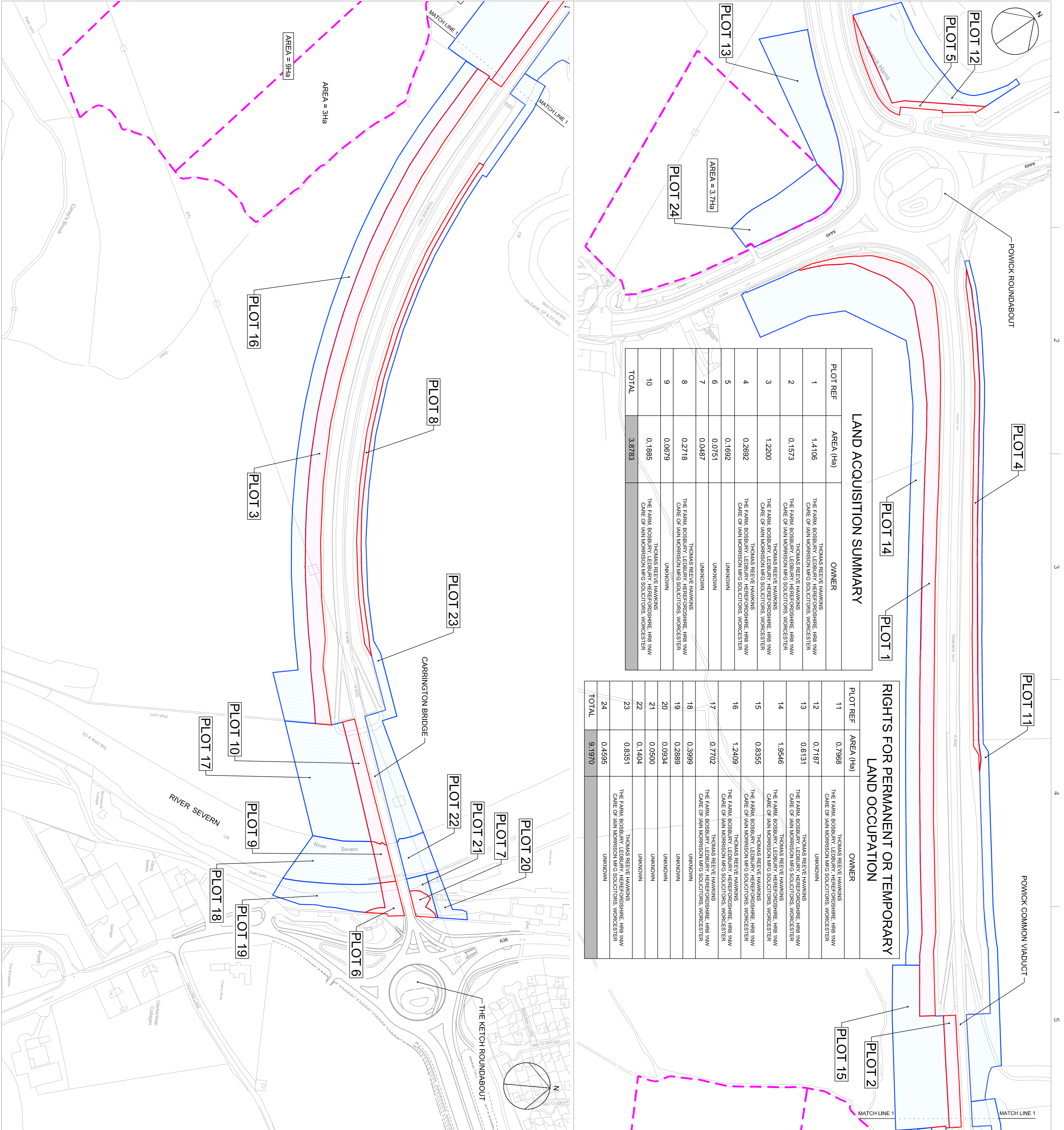

**LAND ACQUISITION SUMMARY**

PLOT REF	AREA (Ha)	OWNER
1	1.4106	THOMAS REEVE HAWKINS THE FARM, BOSBURY, LEDBURY, HEREFORDSHIRE, HR8 1NW CARE OF IAN MORRISON MFG SOLUTIONS, WORCESTER
2	0.1573	THOMAS REEVE HAWKINS THE FARM, BOSBURY, LEDBURY, HEREFORDSHIRE, HR8 1NW CARE OF IAN MORRISON MFG SOLUTIONS, WORCESTER
3	1.2200	THOMAS REEVE HAWKINS THE FARM, BOSBURY, LEDBURY, HEREFORDSHIRE, HR8 1NW CARE OF IAN MORRISON MFG SOLUTIONS, WORCESTER
4	0.2692	THOMAS REEVE HAWKINS THE FARM, BOSBURY, LEDBURY, HEREFORDSHIRE, HR8 1NW CARE OF IAN MORRISON MFG SOLUTIONS, WORCESTER
5	0.1692	UNKNOWN
6	0.0751	UNKNOWN
7	0.0487	UNKNOWN
8	0.2718	THOMAS REEVE HAWKINS THE FARM, BOSBURY, LEDBURY, HEREFORDSHIRE, HR8 1NW CARE OF IAN MORRISON MFG SOLUTIONS, WORCESTER
9	0.0679	UNKNOWN
10	0.1895	THOMAS REEVE HAWKINS THE FARM, BOSBURY, LEDBURY, HEREFORDSHIRE, HR8 1NW CARE OF IAN MORRISON MFG SOLUTIONS, WORCESTER
<b>TOTAL</b>	<b>3.8733</b>	

**RIGHTS FOR PERMANENT OR TEMPORARY LAND OCCUPATION**

PLOT REF	AREA (Ha)	OWNER
11	0.7989	THOMAS REEVE HAWKINS THE FARM, BOSBURY, LEDBURY, HEREFORDSHIRE, HR8 1NW CARE OF IAN MORRISON MFG SOLUTIONS, WORCESTER
12	0.7187	UNKNOWN
13	0.6131	THOMAS REEVE HAWKINS THE FARM, BOSBURY, LEDBURY, HEREFORDSHIRE, HR8 1NW CARE OF IAN MORRISON MFG SOLUTIONS, WORCESTER
14	1.9546	THOMAS REEVE HAWKINS THE FARM, BOSBURY, LEDBURY, HEREFORDSHIRE, HR8 1NW CARE OF IAN MORRISON MFG SOLUTIONS, WORCESTER
15	0.8355	THOMAS REEVE HAWKINS THE FARM, BOSBURY, LEDBURY, HEREFORDSHIRE, HR8 1NW CARE OF IAN MORRISON MFG SOLUTIONS, WORCESTER
16	1.2409	THOMAS REEVE HAWKINS THE FARM, BOSBURY, LEDBURY, HEREFORDSHIRE, HR8 1NW CARE OF IAN MORRISON MFG SOLUTIONS, WORCESTER
17	0.7702	THOMAS REEVE HAWKINS THE FARM, BOSBURY, LEDBURY, HEREFORDSHIRE, HR8 1NW CARE OF IAN MORRISON MFG SOLUTIONS, WORCESTER
18	0.3999	UNKNOWN
19	0.2899	UNKNOWN
20	0.0934	UNKNOWN
21	0.0500	UNKNOWN
22	0.1404	UNKNOWN
23	0.8351	THOMAS REEVE HAWKINS THE FARM, BOSBURY, LEDBURY, HEREFORDSHIRE, HR8 1NW CARE OF IAN MORRISON MFG SOLUTIONS, WORCESTER
24	0.4595	UNKNOWN
<b>TOTAL</b>	<b>9.1970</b>	

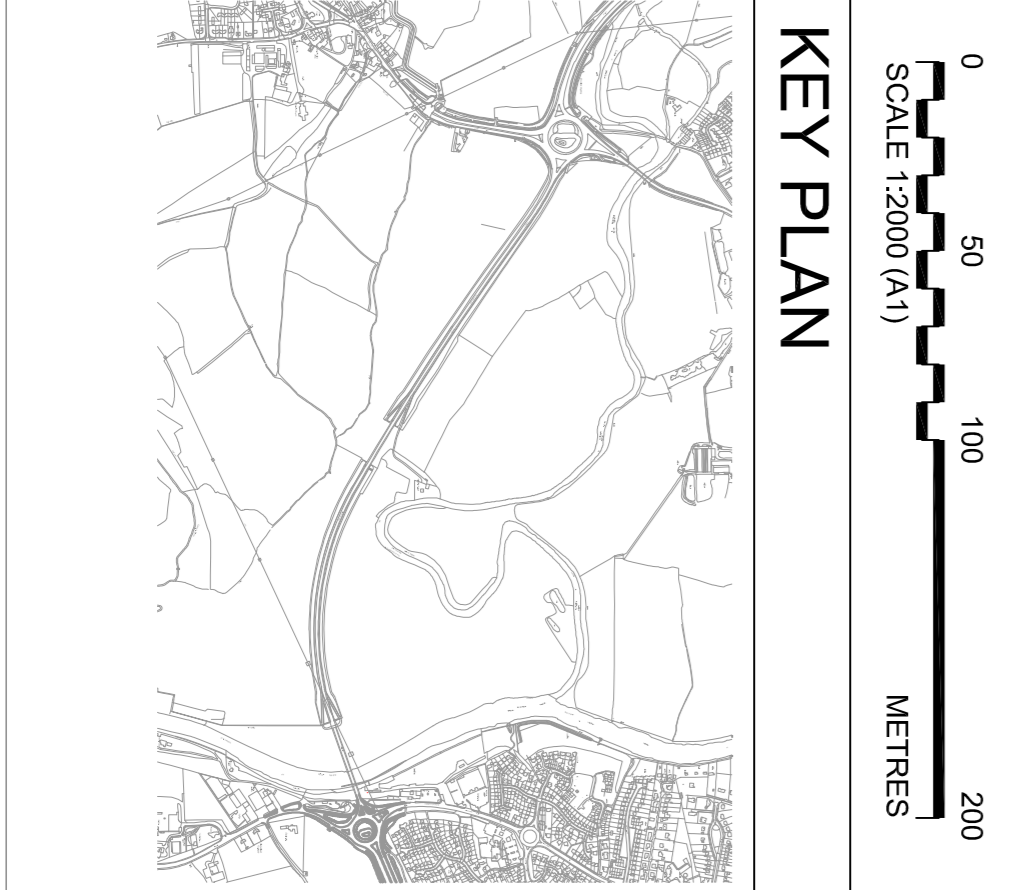

**ch2m**

A4440 WORCESTER SOUTHERN LINK ROAD IMPROVEMENTS PHASE 4

**PROPOSED LAND ACQUISITION**

RED HILL HOUSE, 227 LONDON ROAD  
WORCESTER WR5 2JG (01905 361 361)

**worcestershire**  
countycouncil

COUNTY HALL, SPETCHLEY ROAD  
WORCESTER WR5 2NP

P2	21/02/2017	LAND OWNER DETAILS ADDED	SK	DC	
P1	S2	28/11/2016	ISSUED FOR PRELIMINARY LANDOWNER TALKS	OV	DC
REV	STATUS	DATE	REVISION	BY	APVD
DSGN		DR	CHK	OV	SK
			APVD	DC	
			DRG STATUS	S2	DRG REV
			P2		

1:2000 @ A1  
VERIFY SCALE  
BAR IS 25mm ON ORIGINAL DRAWING  
DATE 28/11/2016  
PROJ 06-CL-DR-0050  
DWG 473946  
SHEET 1 of 1

© CH2M HILL 2013. ALL RIGHTS RESERVED.

REUSE OF DOCUMENTS: THIS DOCUMENT, AND THE IDEAS AND DESIGNS INCORPORATED HEREIN, AS AN INSTRUMENT OF PROFESSIONAL SERVICE, IS THE PROPERTY OF CH2M HILL AND IS NOT TO BE USED, IN WHOLE OR IN PART, FOR ANY OTHER PROJECT WITHOUT THE WRITTEN AUTHORIZATION OF CH2M HILL.